

Cylinder Head/Valve Train

Illustrated Index

(1500 shown; 1300 and 1200 similar)

NOTE: Use new O-rings and gaskets whenever reassembling.

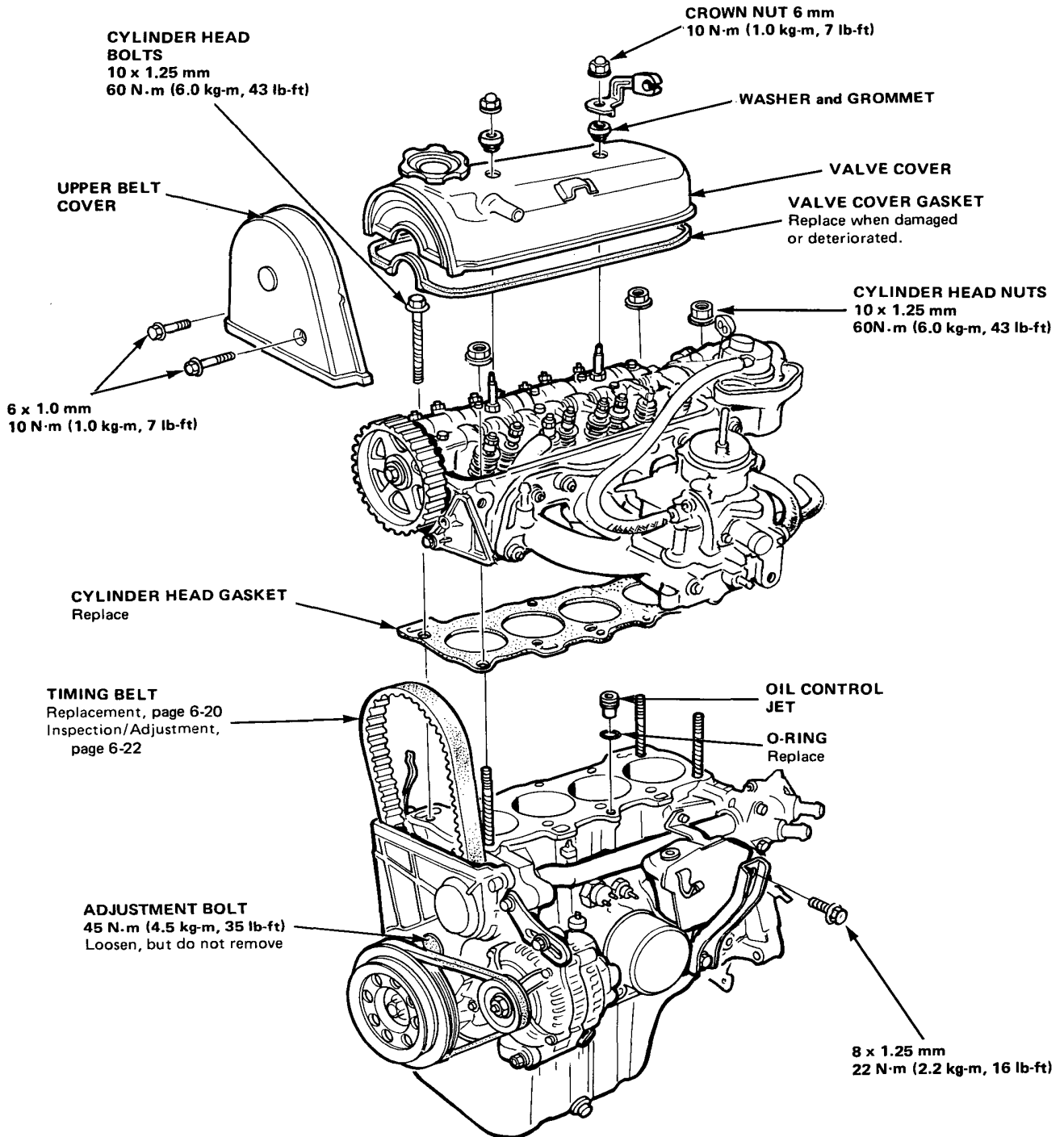



(Coupe)

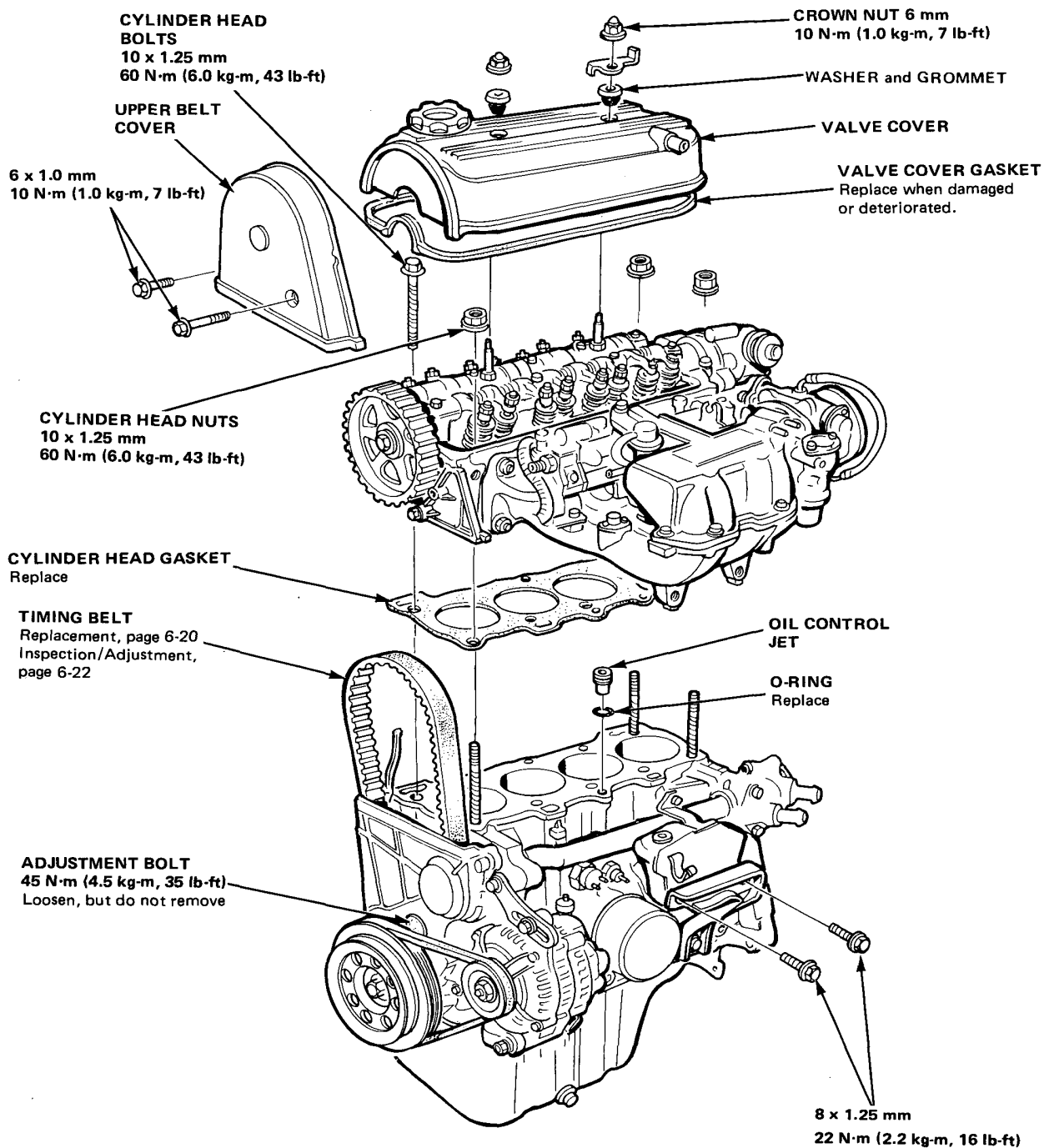

(cont'd)

Cylinder Head/Valve Train

Illustrated (cont'd)

(1500 shown; 1300 and 1200 similar)

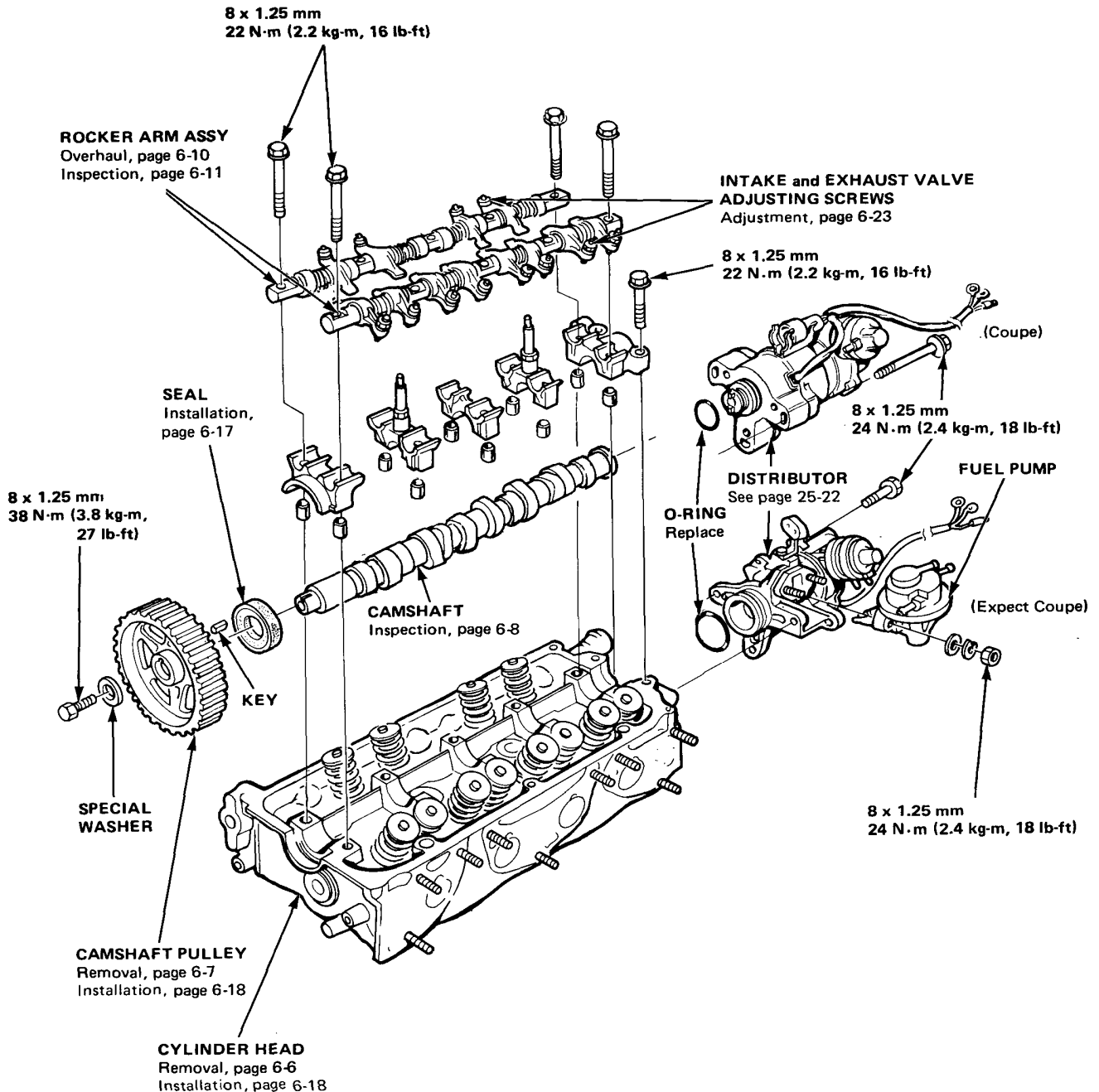



CAUTION: To avoid damaging the cylinder head, wait until the coolant temperature drops below 38°C (100°F) before removing it.

